

PANEL GLIDE Installation Instructions

2-Channel

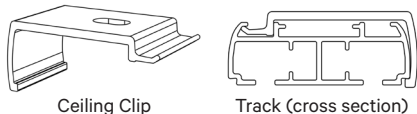

Ceiling Clip

Track (cross section)

3-Channel

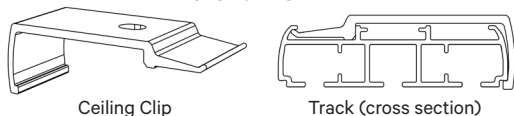

Ceiling Clip

Track (cross section)

4-Channel

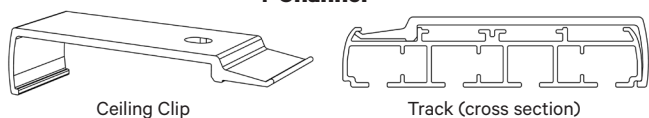

Ceiling Clip

Track (cross section)

5-Channel



Ceiling Clip

Track (cross section)

Headrail Width	Number of Ceiling Clips
< 40"	2
40" - 69"	3
70" - 102"	4
103" - 165"	5
166" - 228"	6

Ceiling Clip Spacing

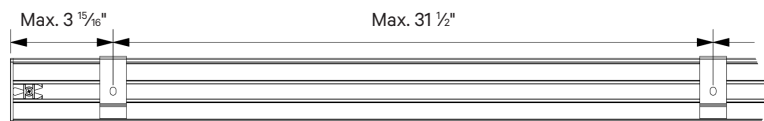

Bridging Tracks

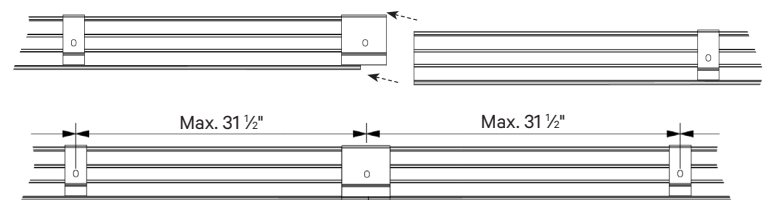

INSTALLING THE HEADRAIL

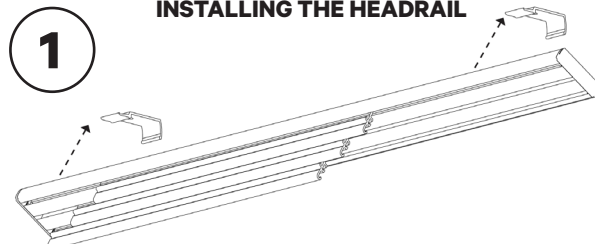

1 After spacing, aligning and installing the ceiling clips, position the track based on proper clip placement.

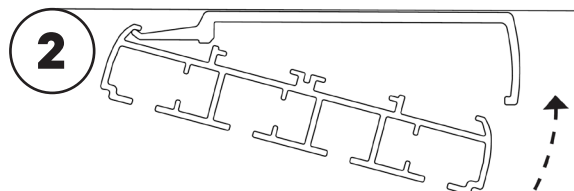

2 Hook the front of the track onto the front of the ceiling clips, and then push the back of the track upward.

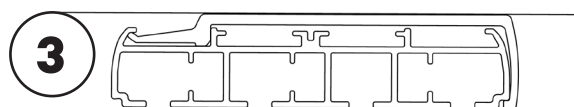

3 Push the back of the track upward until it securely clicks into place in all of the ceiling clips.

INSTALLING THE PANELS (ONTO THE HEADRAIL)

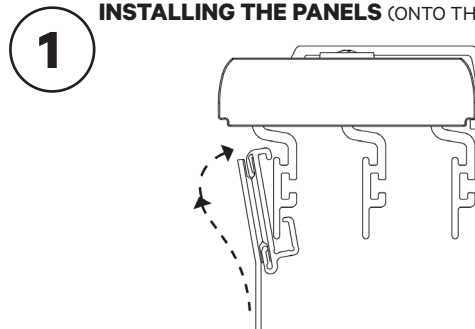

1 With the velcro facing outward, insert the bottom of the sliding profile into the (larger) bottom lip of the velcro strip. Push up/in until the (smaller) upper lip clicks into place.

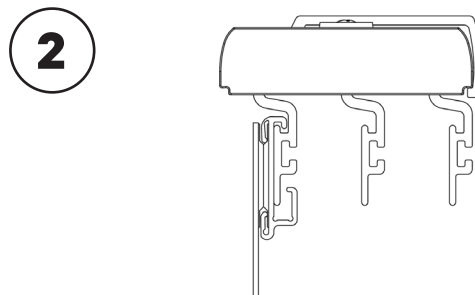

2 Attach the velcro (on the back side of the fabric panel) to the velcro strip on the headrail.

NOTE: Throughout installation, be careful to keep the fabric away from the velcro strip on the headrail. It may snag causing flaws, which is NOT a manufacturing defect and no credit will be issued.